

SABBATH SCHOOL DIRECTORY

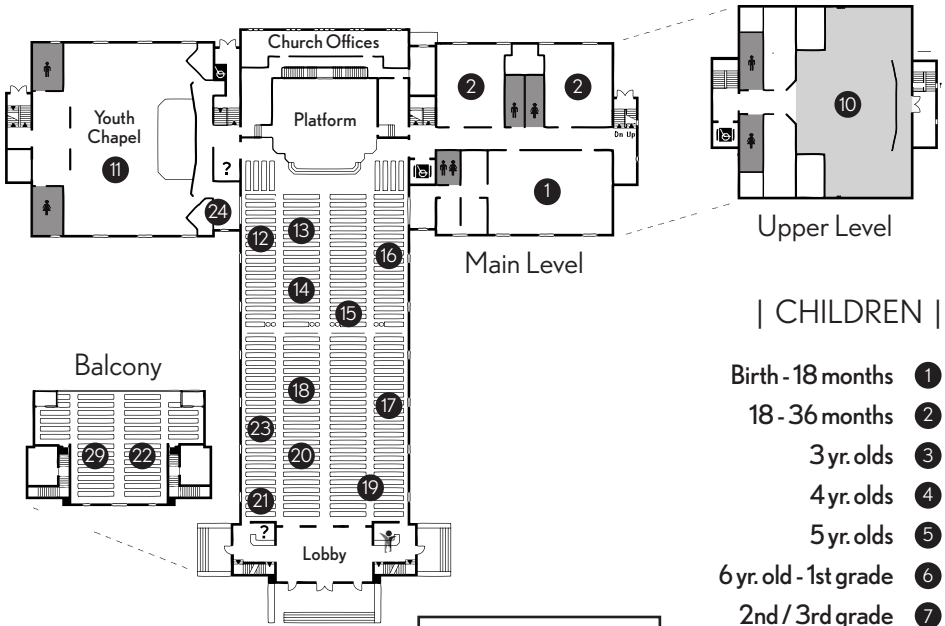

| CHILDREN |

- Birth - 18 months ①
- 18 - 36 months ②
- 3 yr. olds ③
- 4 yr. olds ④
- 5 yr. olds ⑤
- 6 yr. old - 1st grade ⑥
- 2nd / 3rd grade ⑦
- 4th grade ⑧
- 5th / 6th grade ⑨
- Earliteen ⑩
- Youth ⑪

| ADULT |

- ⑫ Group 1
- ⑬ Group 2 (Portuguese/Brazilian)
- ⑭ Group 3
- ⑮ Group 4 (Yugoslavian)
- ⑯ Group 5
- ⑰ Group 6
- ⑱ Group 7
- ⑲ Group 8
- ⑳ Group 9 (Spanish)
- ㉑ Group 10
- ㉒ Group 11 (Balcony)
- ㉓ Group 12 (French)
- ㉔ Conference Room
- ㉕ Something In Common
- ㉖ Young Adult
- ㉗ SDA Beliefs

| KEY |

- ? Welcome Centers
- ⬇ Elevators
- ♿ Restrooms
- 👤 Children's Activities & Lending Library

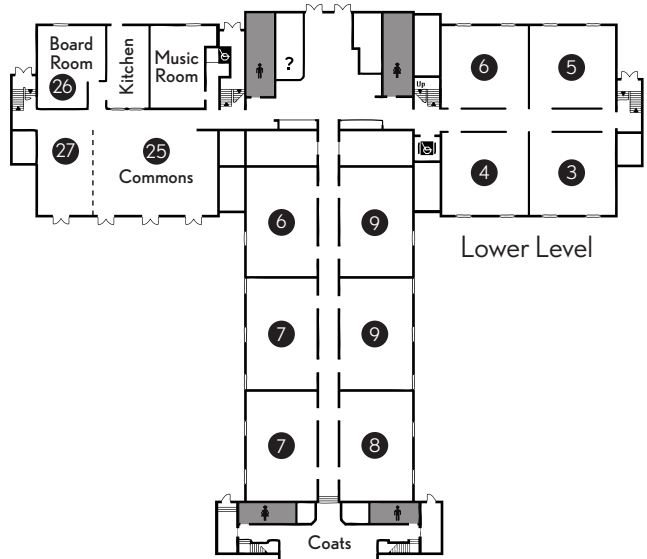

Andrews University Campus Map

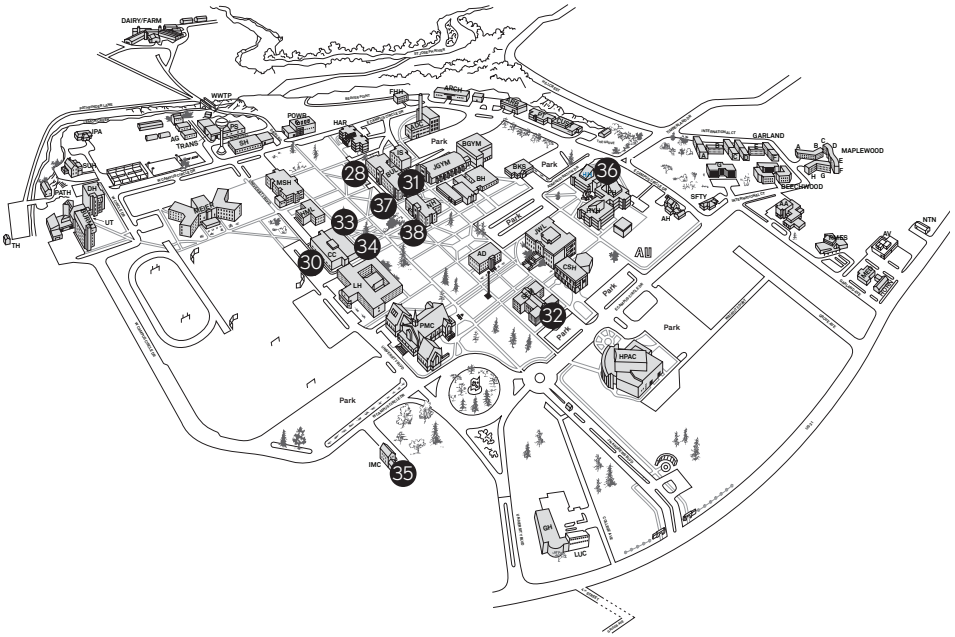

| COLLEGIATE |

- 28 H&M (Hispanic - Religion Amphitheater)
- 29 People on the Move (PMC)
- 30 University Sabbath School (Rec. Center)
- 31 Compass Sabbath School (Buller--Religion Dept.)

| SEMINARY |

- 32 N108 (Collegiate)
- N110 (Small Group)
- N120 (New Life Church Choir)
- N150 (Stefanovic, Moscala, Doukan, Fortin, Jeronic)
- N211 (Small Group)
- N235 (Burrill, van Bemmelen, North, Schalk)
- N310 (Small Group)
- N335 (Spanish--Munoz)
- S335 (Upper Room)

| ADULT @ AU |

- 33 Main Lounge
- 34 Faculty Lounge
- 35 Back to Basics
- 36 Living Word Fellowship
- 37 Current Events (Nethery Hall-134)
- 38 Bible Journey (Nethery - 143)